

# bca landscape

Our work in the Build to Rent sector



CGI by Identity Design: Blackhorse Mills, Walthamstow for Legal & General



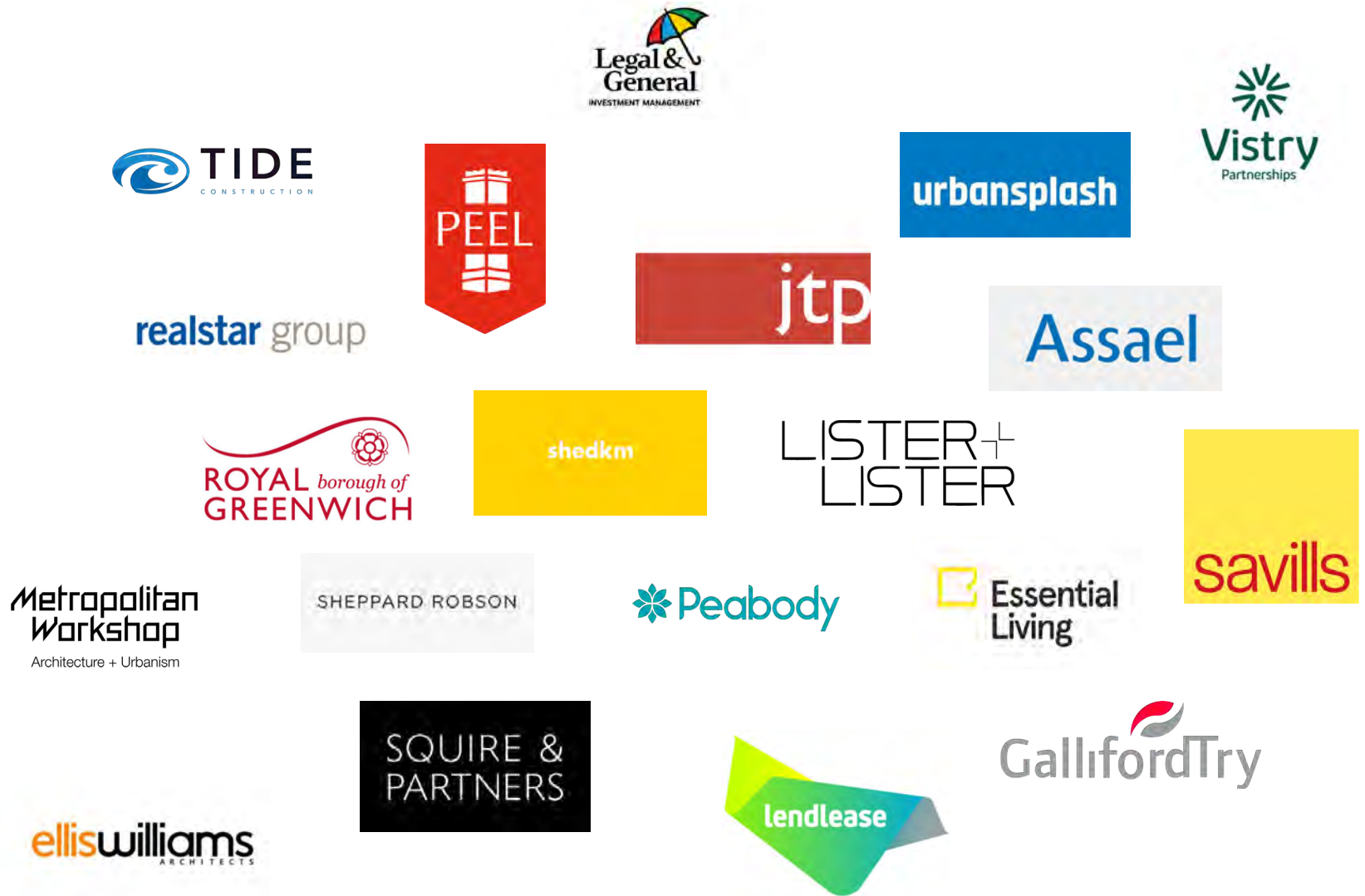

---

# INTRODUCTION

---

BCA Landscape and BTR in brief:

We have been involved in the Build to Rent sector since 2014, providing Landscape Architectural consultancy services for innovative developers and Architects whose logos appear opposite.

Landscape brings people together, working with the internal amenity spaces to create a sense of community and of belonging to something special with its own sense of place.

Our work delivers green and blue infrastructure, which helps to:

- increase biodiversity net gain,
- achieve the required Urban Greening factor,
- improve mental health and well-being,
- move towards net zero carbon outcomes,
- improve air and water quality,
- reduce flood risks
- assist with gaining credits under BREEAM/ LEED etc

We have worked 'client-side' and novated to contractors, mastering the technical complexities of co-ordinating landscape and building elements with the wider design and construction team.

We can also integrate your project with the wider community 'beyond the red line' including development of artwork themes and interventions - either in-house or in collaboration with a wide network of artists and makers.

We ensure that schemes are robust and easy to maintain, keeping down service charges and cost- in-use for replacement when things wear out.

We can deliver you and your funders excellent metrics on all aspects of the green agenda.

We champion all aspects of the landscape design through the whole process from site feasibility to tenants moving in- and beyond!

1,771 new BTR homes delivered, another 1,000 on the way.

We focus on maximising amenity provision and green infrastructure to make your development stand out from the crowd.

Our expert team can be your 'one-stop-shop' for all elements related to landscape from planning to handover and beyond, anywhere in the UK.

Interested?

Please take a look at the following case studies and if you have more time perhaps take a wander through our web site at:

[www.bcalandscape.co.uk](http://www.bcalandscape.co.uk)

We would love to hear from you if you have a scheme to discuss- contact info is on the back page.

## BLACKHORSE MILLS

COMPLETED  
2020

LOCATION  
Ferry Lane, Walthamstow

CLIENT  
Legal and General

[www.blackhorsemills.com](http://www.blackhorsemills.com)

In 2016 BCAL assisted Assael and L&G to secure full planning permission for 479 new BTR homes in 5 new buildings with ground floor commercial uses on the edge of the Walthamstow Wetlands.

BCAL were then novated to Contractor Galliford Try (subsequently Vistry partnerships) at RIBA Stage 4 through to completion in 2020.

This scheme includes a major new 1 Hectare public realm and extensive private amenity, including 6 separate roof gardens, tennis and shuffleboard courts, an outdoor heated 20m swimming pool/ lido with bar, childrens play area, and formal lawn for events.

The whole development is pet-friendly, which has made a big impact in terms of helping new neighbours to connect with each other.



Photo: BCAL





Photo: BCAL



## ST MARY'S QUARTER

### COMPLETED

2016-2019 in 3 phases

### LOCATION

Elephant and Castle, London

### CLIENT

Lend Lease, Realstar, Peabody, London Borough of Southwark

BCAL are proud to have been appointed by 4 separate clients to work collaboratively on this scheme which includes 3 separate buildings: One The Elephant, Castle Leisure Centre and 'Uncle' in Newington Butts.

These provide 754 new homes, a theatre, three cafes, community focused commercial premises and has a mixed tenure of PRS, Social Housing and apartments for sale.

The public realm and enhanced public park unifies the 3 separate buildings and includes a plaza for community events, enhanced traffic-free, well-lit pedestrian connections meandering through groves of pine trees. A series of new water features including a pond, mirror pools and fountain jet plaza.

A major new play area, cafe and roof terraces, dramatic new lighting, green walls, blue roofs, rooftop allotment growing areas and extensive ground level planting and public seating make this a wonderful area to live and work.



Photo: BCAL



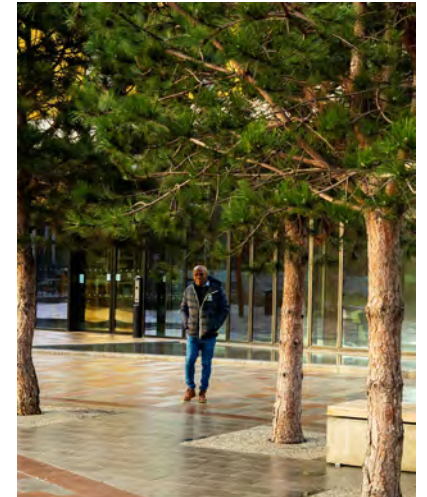
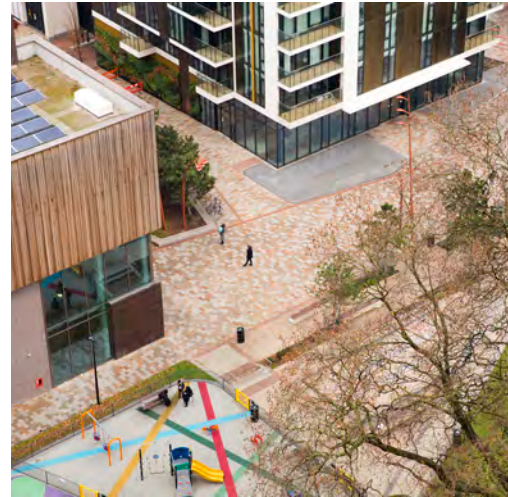

CGI: Squire & Partners



---

## VANTAGE POINT

COMPLETED  
2016

LOCATION  
Archway, London

CLIENT  
Essential Living

Working closely with Essential Living, Architects GRID and interior designers Woods Bagot, the top of the building was transformed into a communal amenity facility with a wide range of indoor and outdoor opportunities for work, rest and play to help foster a sense of community and collective endeavor.

Externally there are growing areas, an outdoor kitchen, extensive seating including loungers and a range of planting habitats which creates a sheltered haven for people and wildlife. Subtle lighting extends the period of use into the evenings and external materials compliment the architecture and interiors.

Spaces were designed to be sub-divided for private exclusive hire and wi-fi boosters and power were provided to allow use of lap-tops for working from home.



Photo: Essential Living web site





Photo: Kinley Systems Ltd.

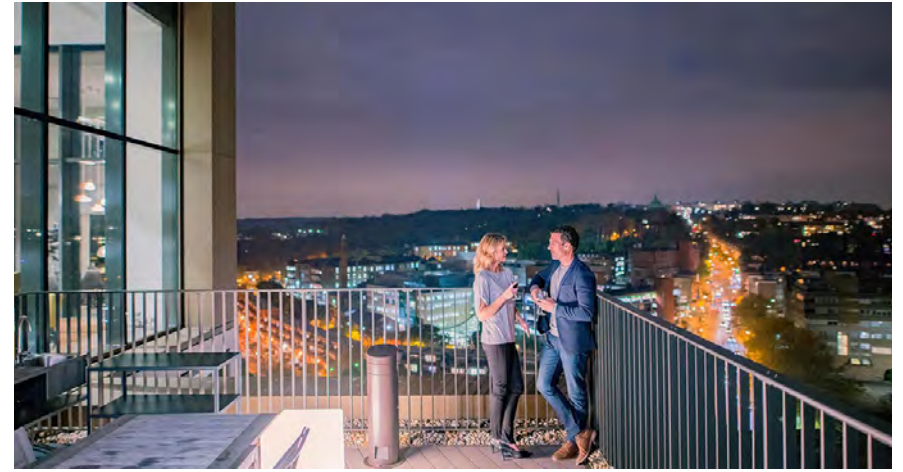

Photo: Essential Living web site



# BOX MAKERS YARD

COMPLETED  
2021

LOCATION  
Temple Meads, Bristol  
CLIENT  
Legal & General

[www.boxmakersyard.com](http://www.boxmakersyard.com)

AWARDS  
What House?: Gold Award for Best Build to Rent

Working closely with Legal & General, Architects Assael, interior designers Lister & Lister, and engineers Jubb, the site has been transformed to provide 376 new homes and is one of the most popular new places to rent in Bristol. A wide range of indoor and outdoor communal amenity facilities for work, rest and play to help foster a sense of community.

Externally there are two roof terraces, ground floor public realm improvements, cafe terrace and communal gardens complementing the ground floor internal 'Clubroom'.

The scheme exploits the fabulous views across Bristol and features specially commissioned artworks from local Poet Beth Calverley (a.k.a The Poetry Machine) which were incorporated into the buildings and landscape by FRA Creative and Hardscape, curated by Catherine Thomas at Art Acumen

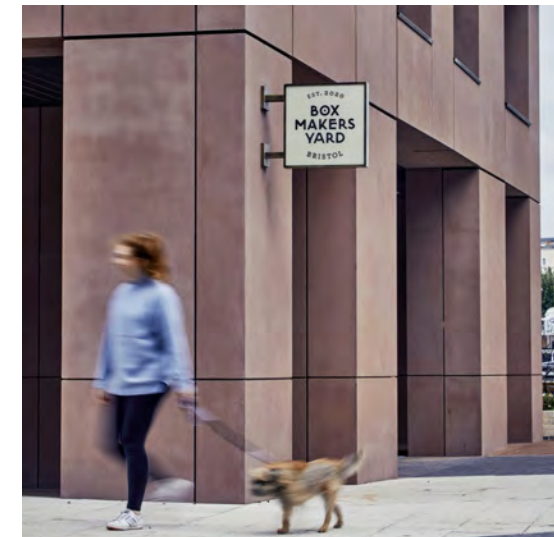
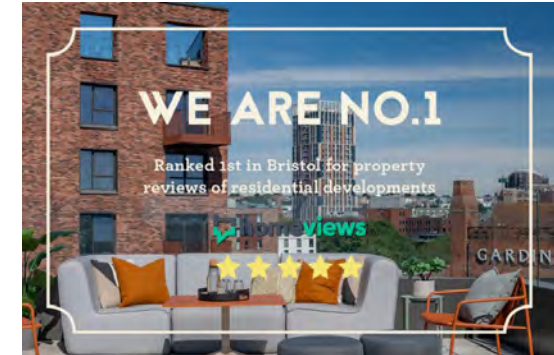

All Photos: Box Makers Yard web site.

CGI of Beth Calverley's poem: BCAL





Photo: Assael Architects web site



---

## GREENWICH HOUSING

### COMPLETED

2019 - ongoing

### LOCATION

Greenwich, London

### CLIENT

Royal Borough of Greenwich

BCAL are appointed as Landscape Architects for this important 100% affordable Zero carbon social housing scheme for Greenwich Builds. The first 11 sites involve over 200 homes, which are all being delivered as modular units, built off-site by Ideal Modular Homes and Mod Pods

BCAL have worked closely with the client, Architects ShedKM, main contractor Elkins Construction, engineers Conisbee and SCMS to handle all aspects of the landscape elements of the scheme including representing landscape matters at public consultation, planning committees, design review panels, discharge of planning conditions, tender packages, construction and as-built packages and site inspection.

The first batch of 4 sites were completed in summer 2021, with further sites following over the next 18 months.



CGI by Cosmocube





All CGIs by Cosmocube



## WIRRAL WATERS

COMPLETED  
2015- ongoing

LOCATION  
Liverpool

CLIENT  
Peel, Urban Splash, Wirral Council

BCA Landscape have been appointed as Landscape Architects for the Wirral Waters project, which is a large scale £4.5bn waterside development proposed by the Peel Group for Birkenhead docklands, on the Wirral Peninsula, England.

Alongside overall landscape masterplanning, BCAL have developed designs and details for the delivery of 6 major projects including: Wirral Metropolitan College, Skills Factory, North Bank residential development with Urban Splash, Care, Office and Retail facilities, as well as extensive new Green Infrastructure and pocket parks working closely with the Mersey Forest initiative.

BCA Landscape have also been responsible for providing proposals for temporary landscape treatments for some of the client's existing disused sites. The proposals form part of a wider initiative to bring leisure and recreational benefits to the area which will in future help to anchor the future waterside development into its context.



CGI by Uniform for Peel Holdings





CGI by Uniform for Urban Splash



---

## EAST FLOAT WIRRAL WATERS

### COMPLETED

Ongoing

### LOCATION

Northbank, Wirral

### CLIENT

Urban Splash and Peel L&P

Northbank is a mixed typology and tenure residential-led quarter, with local community uses, offering a bespoke, more tranquil living environment. A quarter offering city living with 'space to breathe', 'off the beaten track', with access to the waters-edge and a short walk away from other quarters and world destinations.

A new waterside residential quarter featuring 347 pioneering, modern, modular homes is coming to Wirral Waters. Urban Splash developers and architects Shed KM are bringing their factory-built modular home HOUSE to Merseyside for the first time.

BCAL are the project landscape architects and have also designed and delivered advanced landscape infrastructure works, including a new adoptable cycleway and street tree planting along the Dock Road, a new Community Park and additional Dockside landscape works to compliment a series of new phased residential developments along the Northbank East Float.



CGI by Uniform for Urban Splash





CGI by Uniform for Urban Splash



## UNION WHARF- GREENWICH CREEKSIDE

COMPLETED  
2017

LOCATION  
Greenwich, London

CLIENT  
Essential Living

Working closely with Essential Living and architects Assael, an extensive new public realm including creekside walkway and terraces was developed in collaboration with the Creekside Trust environmental charity, who are managing the terraces for Essential Living.

A children's nursery, pocket park and extensive private residential amenity at podium level and 5 separate roof-top terraces make this a family-friendly development.

BCAL worked closely with interior designers Woods Bagot and lighting designers Studio Fractal to create a co-ordinated amenity design inside and outside the buildings.

Extensive green walls, green and brown roofs and the inter-tidal terraces combine with the carefully chosen wildlife-friendly ground level planting to give a major enhancement to the area's biodiversity.



CGI supplied by Assael Architects





Photos: Green wall and sculptural sign by BCAL, Rooftop terrace from Essential Living Website



---

# THANK YOU

If you are interested in our work and how we can help you to deliver any projects, please don't hesitate to get in touch!

Call me direct on 0776 523 5337  
or our studio on 0151 242 6161 or  
e-mail: [michael@bcandscape.co.uk](mailto:michael@bcandscape.co.uk)

Michael O'Connell  
Director BCA Landscape

BCA Landscape  
19 Old Hall St  
Liverpool L3 9JQ  
—  
[www.bcandscape.co.uk](http://www.bcandscape.co.uk)